

# TECHNICAL INFORMATION

QTY OF ELEVATORS	
TYPE	ROPED HYDRAULIC/HANDICAPPED
APPLICABLE CODE	
RATED LOAD—LBS/WEIGHT CAB	750lbs/350lbs
SURFACE	
PERSONS	2
SPEED	
OPERATION	CONSTANT PRESSURE
SELF LEVELLING	AUTOMATIC
LANDINGS/OPENINGS	
HOISTWAY DOORS	MANUAL SWING
INTERLOCK TYPE	PRUD'HOMME
VOLTAGE/PHASE/CYCLE	
STARTING AMP.	
FULL LOAD AMP.	
CONTROLLER	JRT
MOTOR	
PUMP	
VALVE	
OIL FLOW	
Ø OIL LINE PIPE	Ø6.35mm [Ø1/4"] 100R2
WORKING PRESSURE	
Ø PISTON/WALL	
Ø CYLINDER/WALL	
REQUIRED OIL	
RAILS	4.76mm [3/16"]
GUIDES	TIVAR
STEADIER	FIX
PULLEY DIAMETER	Ø273mm [Ø10 3/4"]
CABLES	Ø6.4mm [Ø1/4"] 7X19 AIRCRAFT
BREAKING STRENGTH	3175Kg [7000LBS]

## TOWER FINISH:

### REACTION

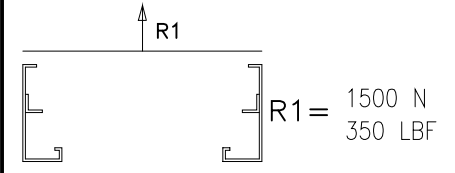

0	NOV.07'06		
REV.:	DATE:	DESCRIPTION:	BY:
DRAWING NAME: ELEVATOR LAYOUT			
ELEVATOR(S) NUMBER:			
DETAILS: GT SMARTLIFT FRONT-SIDE ENTRANCE (103)			
PROJECT NAME:			
LOCATION:			
<small>LE GROUPE MANUFACTURIER D'ASCENSEURS</small> <b>GLOBAL TARDIF</b> <small>ELEVATOR MANUFACTURING GROUP</small>			
DRAWN BY:	VERIFIED BY:	DATE:	SCALE: N.T.S.
REF.:	DRAWING #:	SHEET:	REV: 0

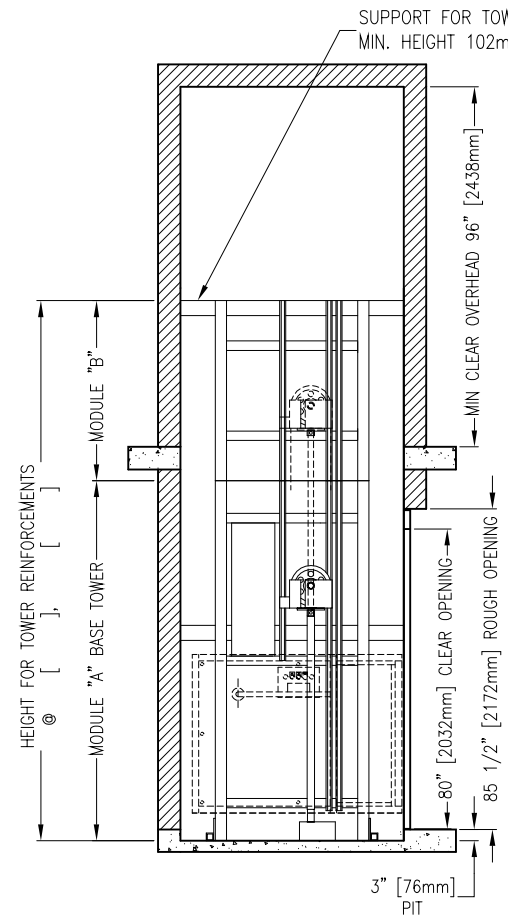
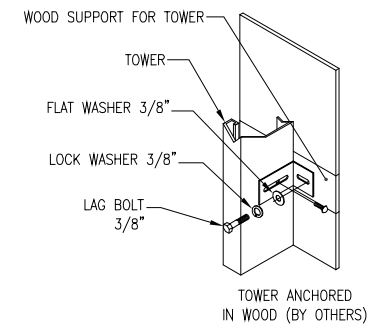
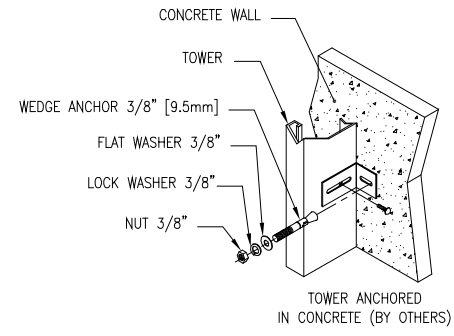
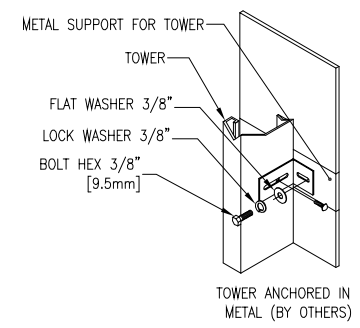

ELEVATION VIEW  
(MECHANICAL ELEMENTS)

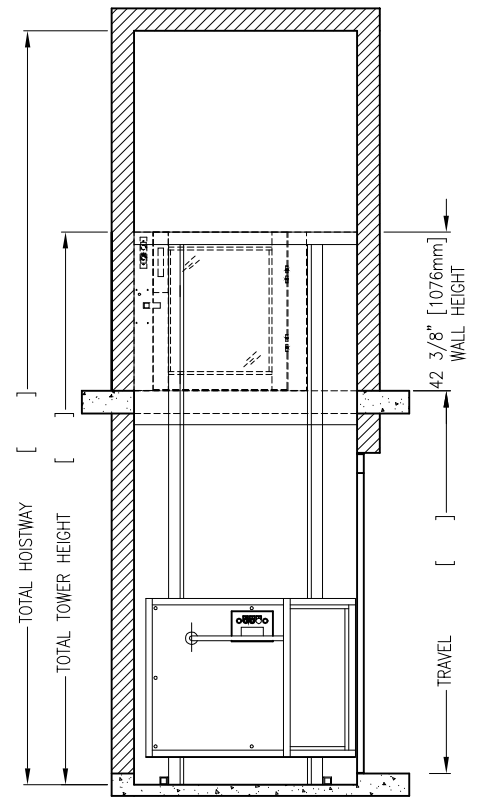

ELEVATION VIEW  
(WITH WING WALLS & FASCIA)

CYLINDER	
HEIGHT OF CYLINDER	
PRE-EXTENSION	
EXTENSION	